

TDX ENTRIES (X101 - X103)

- X103 1 **fail** **CH ROCKVILLE'S SILVER DAY ON THE MOUND BN RI TD JH BCAT RATN** - SR85897307 1/16/15
 Breeders: Debbie & Bruce Gross & Kristina Muratori. By GCH Rockville's Silver Firewalker CD BN RA JH THD TKD RATCH3 x CH Rockville's Tara Of Twelve Oaks CDX BN GN RA JH NAP NFP NAJ DCAT RATO TKA.
Owners: Debbie & Bruce Gross & Kristina Muratori, 4167 Stonefield Lane, Fairfield, CA 94534. (Weimaraner, Bitch)

TDX ALTERNATES (X104 - X108)

- X104 alt **PASS** **CH DUSTRAX GRAND SLAM TD** - SR74621702 9/12/12
 Breeders: Kathryn McIntyre & Ralph Webber. By GCH Stonecrests Super Cruiser RN JH x CH Huntleigh Dustrax Oh So Special VCD1 TDX RE AX AXJ. **Owners: Kathryn McIntyre & Ralph Webber**, 10283 Mt. Vernon Rd., Auburn, CA 95603. (Golden Retriever, Dog)
- X105 **GCH FOG HORN APOLLO BN RA TD CGC** - WS33405201 1/12/10
 Breeders: Judy & Torin Knorr. By CH Pouch Cove's Orion Leal RA x CH Cortereal Electra VCD1 RE TDX AX AXJ NAP NJP NFP.
Owners: Judy & Torin Knorr, 1120 Palm Ave, San Mateo, CA 94401. (Portugese Water Dog, Dog)
- X106 **CH ETERNITY'S GOLD COUNTRY BOY-SUTTER RN TD AX AXJ MXF** - SR78274203 5/5/13
 Breeders: Terrie LaRue. By CH Kamp's Normandy N Rubic's Just Cruising x CH Eternity's It's About Time. **Owners: Sue & Jeffery Thomsen**, P.O. Box 212, Nevada City, CA 95959.
 (Cocker Spaniel, Dog)
- X107 **XEE LO VON SONTAUSEN TD** - DN33948501 5/12/12
 Breeder: Julie Priest. By Diego-Armando von der Roggenstrasse x Rixi von Sontausen. **Owners: Jindra & Douglas Goodman**, 1081 Seth Court, San Jose, CA 95120. (German Shepherd Dog, Dog)
- X108 **DD'S RANCH RABBIT VCD2 UD RE AX AXJ NF SWN SCA SIA SEA SHDN** - SR58943601 9/18/09
 Breeder: Dee Dee Anderson. By CH Masters Boys 'n' Their Toys CD BN RE NAP NJP x NOC OTCH DD's Dreams Do Come True VCD1 UDX26 OGM RE TDX JH. **Owner: Billy Anderson**, 19681 Brandt Road, Lodi, CA 95240. (Golden Retriever, Bitch)

My sincere thanks to everyone - judges, committee chairpersons, PAFTA members, and our tracklayers. Without you this tracking test would not have been possible. Your help and support are greatly appreciated.

Linda Knowles, Test Secretary

CATALOG

PALO ALTO FOOTHILLS TRACKING ASSOCIATION, INC.

**Combined All-Breed Tracking Dog Test
& Tracking Dog Excellent Test**



**AKC Licensed Event # 2019285403 (TD)
AKC Licensed Event # 2019285402 (TDX)**

Anderson / Coyote Creek Parkway Trailhead

19245 Malaguerra Avenue
Morgan Hill, California 95037

SUNDAY, MARCH 10, 2019

Test Hours: 6:00 AM - 6:00 PM

ENTRIES LIMITED: TD - 3 Dogs TDX - 3 Dogs

Drawing for track assignments for TD will begin at 8:00 a.m.
and for TDX will begin at 10:00 a.m. at the
Test Headquarters at 19245 Malaguerra Avenue, Morgan Hill.

Judging will begin as soon as the tracks have aged sufficiently.



AMERICAN KENNEL CLUB CERTIFICATION

Permission has been granted by the American Kennel Club for the holding of this event under the American Kennel Club Rules and Regulations.

Gina M. DiNardo, Executive Secretary

JUDGES

Mr. Robert Rollins (TD/TDX)..... 909 Los Robles Street, Davis, CA 95618
 Ms. Kamrin MacKnight (TD/TDX)..... 196 Encinal Ave., Atherton, CA 94027
 Ms. Cheryl Bavister (TD) 19802 Sprague Court, Castro Valley, CA 94546

OFFICERS OF THE CLUB

President Karey Krauter
 Vice President Dimity Mueller
 Treasurer Cindy levers
 Secretary Kamrin MacKnight
 196 Encinal Avenue, Atherton, CA 94027

BOARD OF DIRECTORS

Past President Mary Ann Graziano
 Directors Linda Knowles, Dick Symons, Carol Vesely, Janis Welsh

TRACKING TEST SECRETARY

Linda Knowles
 509 Safari Drive, San Jose, CA 95123, phone: 408-362-0328
 cell phone (for weekend of test only): 408-489-2127
 email: vcd3tervs@att.net

TRACKING TEST COMMITTEE

Linda Knowles, Test Chairperson
 Cindy levers, Chief Tracklayer
 And All Officers and Directors of the Association

AWARDS: An award will be offered for each dog passing the test.

AMBULANCE: AMR 911
 POLICE: Santa Clara Sheriff 911
 FIRE: Santa Clara Fire District 911
 HOSPITAL: Kaiser Permanente San Jose Medical Center,
 250 Hospital Pkwy, San Jose, CA 95119..... 408-972-3000

ANIMAL EMERGENCY SERVICES:

Emergency Animal Clinic, 5440 Thornwood Drive, San Jose 408-578-5622

TRACKING TEST SECRETARY'S CERTIFICATION

I hereby certify as to the correctness of the within marked awards and
 absentees, as taken from the Judges' books.

Tracking Test Secretary

TD ENTRIES (T101 - T103)

- T101 3 **CH ENDEAVOR'S INHERIT THE WIND BN RN SC NA NAJ CGCA -**
 fail HP43828101 8/3/12 Breeders: Libby DeMille & Linda Stewart. By
 GCH DC Endeavor's Kickoff At Meisterhaus SC x Taliesin Soul Food.
Owners: Dale Noble & Libby DeMille & Linda Stewart, 505 Bens
 Way, Watsonville, CA 95076. Certified by C. Bavister on 1/6/19.
 (Whippet, Bitch)
- T102 2 **VISTA HOW ABOUT NOW - DN48374004 12/14/16**
 fail Breeders: Cristine Currie & Maureen Scheall. By Epic x Jetstream
 Fujita Whip. **Owner: Karey Krauter**, 374 Stanford Ave., Palo Alto,
 CA 94306. Certified by C. Bavister on 2/10/19. (Border Collie, Dog)
- T103 ABS **SH SHASTA MEET AND GREET BN RA JH AX OAJ OF BCAT TKA**
 SR88567504 6/22/15 Breeder: Joyce Brackney. By CH MACH
 Shasta Leather BN RN JH T2B x CH MACH8 Shasta Black Coffee RN
 JH T2B2. **Owner: Barbara Fowler**, 1428 Brookdale Dr., San Jose,
 CA 95125. Certified by C. Bavister on 1/6/19.
 (Flat-Coated Retriever, Bitch)

TD ALTERNATES (T104 - T105)

- T104 1 **GCH DC SOLOW CRAIGWOOD'S I'M PERSNICKETY - HP48710102**
 11/27/14 Breeders: Linda Cail & Christine Fleishauer.
 PASS By GCH Splash The Professor x GCH SoLow Craigwood's Tie Bow.
Owners: L Cain/S Campbell/L Steele/C Fleishauer, 7935
 Morningstar Dr., Granite Bay, CA 95746. Certified by M. Azevedo on
 2/14/19. (Basset Hound, Bitch)
- T105 WD **(WITHDRAWN) JETTA VON SENTINELHARTS - DN44727104**
 11/25/15 Breeder: SentinelHarts. By "V" Gerry von Weltwitz x
 O'Riley von Hauental PT HSAs HIAs HXAs. **Owner: Cindy levers**,
 50 Hartford Ave., San Carlos, CA 94070. Certified by C. Bavister on
 1/6/19. (German Shepherd Dog, Bitch)

TDX ENTRIES (X101 - X103)

- X101 3 **ROSEKNOLL'S JACK OF ALL TRADES CD BN RN TD NF -**
 fail WS50857802 5/15/15 Breeders: P Henneberry/K Mallory/
 S Teasley/C Teasley. By CH Roseknoll Sailor Da Cortereal x CH
 Roseknoll Sailor Da Cortereal. **Owners: Janis & Chris Welsh**, 7100
 Royal Ridge Dr., San Jose, CA 95120. (Portugese Water Dog, Dog)
- X102 2 **CH SCHOFIELD CORY'S CHEVEHO TD JH - SR76896406 3/21/13**
 Breeder: Robert Schmidt. By CH Schofield Here Comes De Encore x
 CH Schofield Take Me To D' Limit JH. **Owner: Sherrie McClung**,
 1212 Greenbriar Ave., San Jose, CA 95128. (Gordon Setter, Dog)

JUDGES' NOTES

TD ENTRIES (T101 - T103)

T101._____ (Whippet, Bitch) HP43828101

T102._____ (Border Collie, Dog) DN48374004

T103._____ (Flatcoated Retriever, Bitch) SR88567504

TD ALTERNATES (T104 - T105)

T104._____ (Basset Hound, Bitch) HP48710102

T105._____ (Withdrawn)

TDX ENTRIES (X101 - X103)

X101._____ (Portugese Water Dog, Dog) WS50857802

X102._____ (Gordon Setter, Dog) SR76896406

X103._____ (Weimaraner, Bitch) SR85897307

TDX ALTERNATES (X104 - X108)

X104._____ (Golden Retriever, Dog) SR74621702

X105._____ (Portugese Water Dog, Dog) WS33405201

X106._____ (Cocker Spaniel, Dog) SR78274203

X107._____ (German Shepherd Dog, Dog) DN33948501

X108._____ (Golden Retriever, Bitch) SR58943601

JUDGES' NOTES

TD ENTRIES (T101 - T103)

T101._____ (Whippet, Bitch) HP43828101

T102._____ (Border Collie, Dog) DN48374004

T103._____ (Flatcoated Retriever, Bitch) SR88567504

TD ALTERNATES (T104 - T105)

T104._____ (Basset Hound, Bitch) HP48710102

T105._____ (Withdrawn)

TDX ENTRIES (X101 - X103)

X101._____ (Portugese Water Dog, Dog) WS50857802

X102._____ (Gordon Setter, Dog) SR76896406

X103._____ (Weimaraner, Bitch) SR85897307

TDX ALTERNATES (X104 - X108)

X104._____ (Golden Retriever, Dog) SR74621702

X105._____ (Portugese Water Dog, Dog) WS33405201

X106._____ (Cocker Spaniel, Dog) SR78274203

X107._____ (German Shepherd Dog, Dog) DN33948501

X108._____ (Golden Retriever, Bitch) SR58943601



AMERICAN
KENNEL CLUB®

USE FOR: TRACKING Events

70

EVENT SECRETARY'S REPORT

This report and all other submission of records must be received by The American Kennel Club within 7 days of the last day of this event.

CLUB NAME PALO ALTO FOOTHILLS TRACKING ASSOCIATION, INC.

MISCONDUCT INFORMATION:

Was there any misconduct OR were there any complaints OR irregularities of any kind in connection with the Trial, OR any matters requiring attention of the Field Trial Committee under any of the rules or procedures? Yes ☐ No ☒

LOCATION OF TRIAL ANDERSON LAKE / COYOTE CREEK PARKWAY, MORGAN HILL, CA
If location different from that originally approved by the AKC, attach full explanation.

DATES OF EVENT: SUNDAY, MARCH 10, 2019 EVENT # _____

Total number of ENTRIES:

3

X \$3.50* =

Total amount of Recording Fees:

10.50

* Total fees include \$3.00 Event Service Fee and \$.50 Recording fee per entry.

Were there any last minute judge changes or substitutions? Yes ☐ No ☒ Give reasons for each approved advertised judge or additional judge not judging his/her approved assignment.

Were there any complaints over the judging? Yes ☐ No ☒ If "Yes," please make complete report and attach.

Was the place where the Trial was held satisfactory? Yes ☒ No ☐ If "No," please submit a supplemental report giving details.

Was any protest against a dog made to the Field Trial Committee? Yes ☐ No ☒ If "Yes," attach a full report of the proceedings.

List names and members of Field Trial Committee who were present during the running of the Trial, and the approximate hours and dates each was present.

SUNDAY, MARCH 10 - 7:00 AM - 2:30 PM - LINDA KNOWLES, CINDY LEVERS,

DICK SYMONS, KAMRIN DACKNIGHT, LYNNE BENSON-COLBERT

11:00 - 2:30 - DIGNITY MUELLER

9:00 - 2:30 - JANIS WELSH

7:30 - 12:00 KAREY KRAUTER

Linda Knowles
EVENT SECRETARY SIGNATURE

3/11/19
DATE

Address: 509 SAFARI DR
SAN JOSE CA 95123

Tel/Email: 408 362-0328

*Recording Fees may be paid by credit card or by check - Do not submit form via Email. Mail or Fax only.

Payment Method: ☐ VISA ☐ AMEX ☐ MasterCard ☐ Discover

☐ Check or money order made payable to: The American Kennel Club

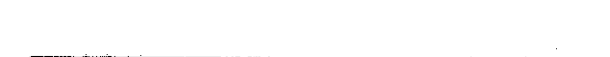
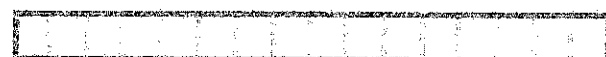

Account Number (do not include dashes)

Expiration Date

Printed Name of Cardholder

PO Box 900051

Raleigh, NC 27675-9051

Tel 919 816-3908

Fax 919 816-4211

Event Number: 2019285403

JUDGE'S BOOK FOR TRACKING
TD or TDU, TDX, AND VST
(Please Circle One)

Name of Club: PALO ALTO FOOTHILLS TRACKING ASSOCIATION, INC.

Date: 3/10/19 Judge: CHERYL BAVISTER

Scheduled Drawing Time: 8:00 AM Total No. Dogs to be Judged: 3

Catalogue Numbers of Dogs Entered in the Test: 7101, 7102, 7104
(7103 WAS ABSENT)

PROCEDURE FOR JUDGES TO FOLLOW

For each dog entered, a separate track shall be plotted by one or both Judges for a TD or TDU tracking test, by both Judges for a TDX and a VST tracking test. The tracks shall be plotted at least the day prior to the test and marked by flags that the tracklayer can readily follow on the day of the test.

A set of charts consisting of one original and three (3) copies of each track shall be prepared by each Judge, showing the approximate length in yards of each leg, major landmarks and boundaries, if any. The track is to be charted by a solid line and each Judge will mark with a broken line, the approximate course taken by the dog, then complete the data requested on the chart and sign each chart. A separate chart must be prepared in the same manner for each dog.

Each Judges shall mark a chart at the time the dog is tracking, so as to show the approximate course followed by the dog. The Judges shall sign his/her charts and show on each whether the dog passed or failed and whether all requirements of the TD or TDU, TDX or VST test were met.

Information on the chart shall also include the following: (See Sample Charts)

Dog's Catalog No.	Track No.	Total Yards
Total Yards Veg.	Total Yards Non-Vegetation	Passed/Failed
Articles	Breed/Sex	AKC Reg. No.
Ground Conditions	Time Tracklayer Started	
Obstacles/Surfaces	Time X-Tracklayer Started	
Dog's Starting Time	Dog's Finishing Time	
Weather Conditions	Wind Direction at the Start	

If a dog is not tracking, it shall not be marked "passed" even though it may have found the article(s).

Upon completion of the test, the Tracking Secretary shall forward the marked copies of the charts to The American Kennel Club, and keep one set for the club files. Each Judge will retain a copy of all charts.

Cheryl Bavister
Signature of Judge

Chart the track in a solid line; the dog's course in broken line on graph below. VEG 460 NON-VEG



CLUB PHFTH DATE 3/10/09 EVENT # 2017259409

TD TDX

TRACK # 1 DOG'S CATALOG # 5164 TOTAL YDS 460

TDU VST

Chart the track in a solid line; the dog's course in broken line on graph below. VEG _____ NON-VEG _____

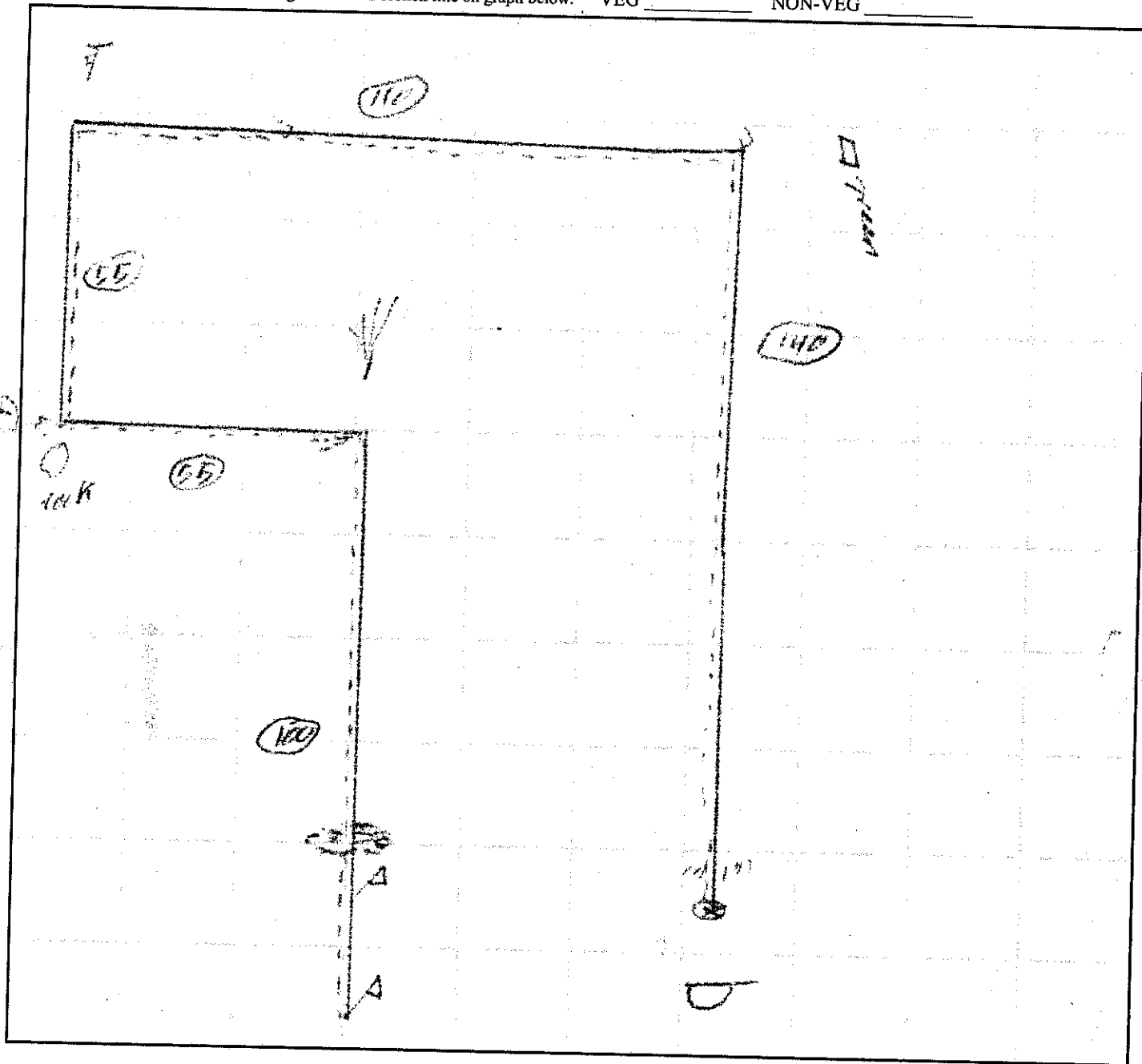

Time Tracklayer Started 0800

Ground Conditions wet green

Breed Border Collie

Time X-tracker Started —

Wind Conditions calm

Sex ♀

Dog's Starting Time 0832

Weather overcast

AKC # HT 4007 K102

Dog's Finishing Time 0852

If dog is absent, mark "absent" on the page.

PASSED

FAILED

Articles

Obstacles/Surfaces

(If failed, state reason)

1. start
2. slare
3. —
4. —

1. —
2. —
3. —
4. —

I hereby certify that I have judged the above dog after having read the instructions on the cover of this book and followed them to the best of my ability.

Judge's Signature

Chart the track in a solid line; the dog's course in broken line on graph below.

VEG 450 NON-VEG

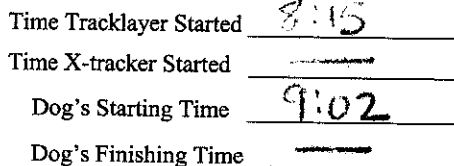

Ground Conditions DAMP
Wind Conditions Calm
Weather Cool

Breed BORDER COLLIE
Sex ♂ MALE
AKC # DN48374004

If dog is absent, mark "absent" on the page.

PASSED FAILED
OFF TRACK
(If failed, state reason)

1. SOCK 2. GLOVE
3. — 4. —

1. _____ 2. _____
3. _____ 4. _____

I hereby certify that I have judged the above dog after having read the instructions on the cover of this book and followed them to the best of my ability.

Cheryl Cavisto
Judge's Signature

CLUB PHETH DATE 3/10/19 EVENT # 2019235403
TRACK # 2 DOG'S CATALOG # 7102 TOTAL YDS 450

TD TDX
TDU VST

Chart the track in a solid line; the dog's course in broken line on graph below. VEG _____ NON-VEG _____

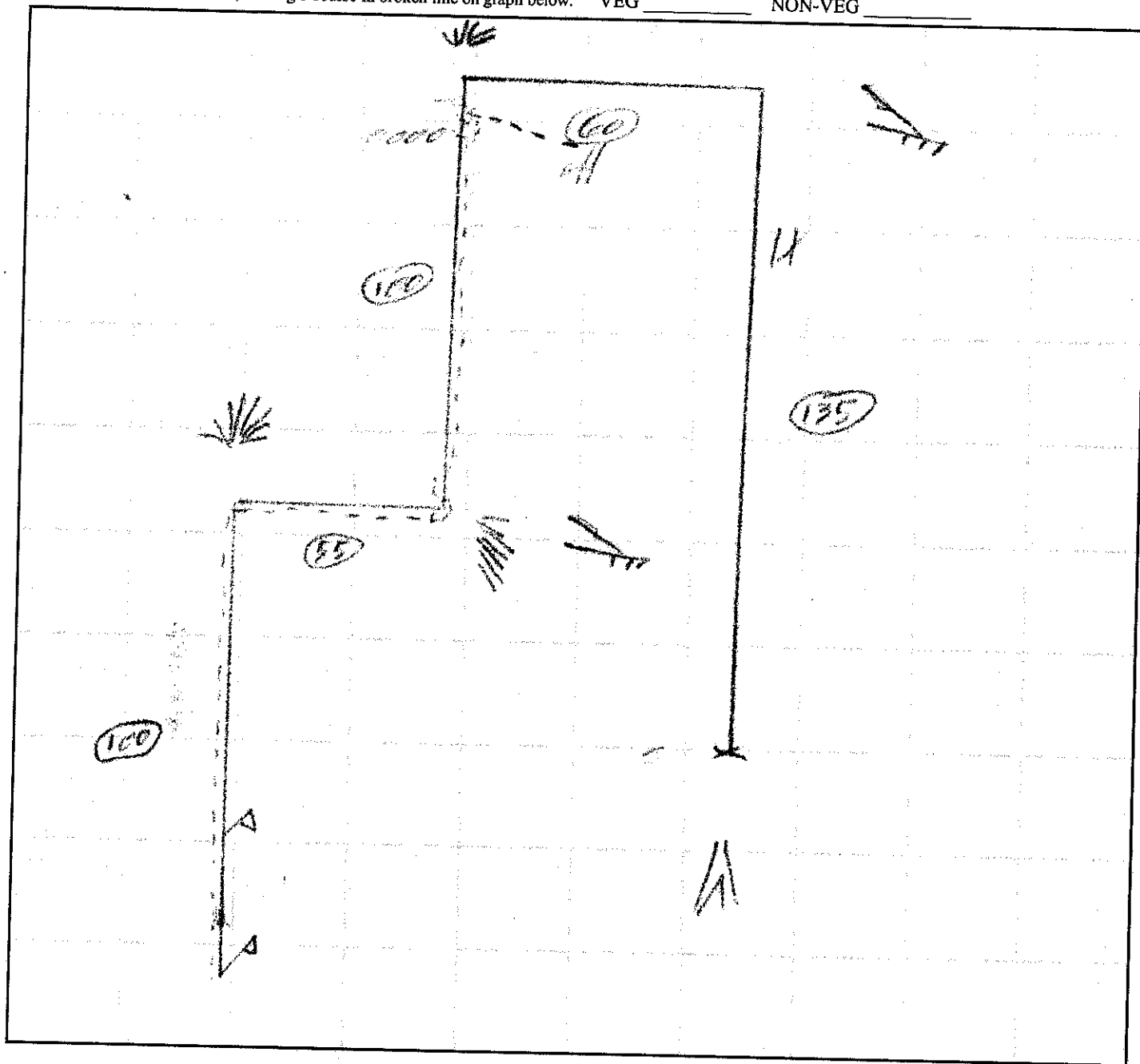

Time Tracklayer Started 2:15
Time X-tracker Started -
Dog's Starting Time 1:02
Dog's Finishing Time _____

Ground Conditions wet grass
Wind Conditions calm
Weather overcast

Breed Border Collie
Sex ♂
AKC # DA44274009

If dog is absent, mark "absent" on the page.

PASSED

FAILED

Articles

Obstacles/Surfaces

1. scout 2. grass
3. - 4. -

1. - 2. -
3. - 4. -

I hereby certify that I have judged the above dog after having read the instructions on the cover of this book and followed them to the best of my ability.

[Signature]
Judge's Signature

VEG 470 NON-VEG —



NON-VEG

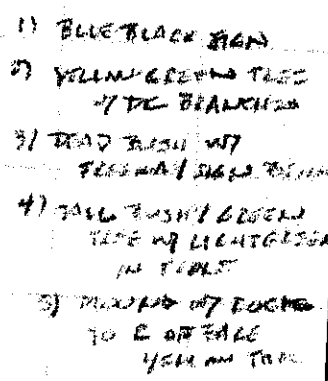

Judge's Signature



AMERICAN
KENNEL CLUB®

USE FOR: TRACKING Events

7DX

EVENT SECRETARY'S REPORT

This report and all other submission of records **must be received** by The American Kennel Club **within 7 days** of the last day of this event.

CLUB NAME PALO ALTO FOOTHILLS TRACKING ASSOCIATION, INC.

MISCONDUCT INFORMATION:

Was there any misconduct OR were there any complaints OR irregularities of any kind in connection with the Trial, OR any matters requiring attention of the Field Trial Committee under any of the rules or procedures? Yes ☐ No ☒

LOCATION OF TRIAL ANDERSON LAKE / COYOTE CREEK PARKWAY, MORGAN HILL, CA
If location different from that originally approved by the AKC, attach full explanation.

DATES OF EVENT: SUNDAY, MARCH 10, 2019 EVENT # 2019285402

Total number of ENTRIES: 4 X \$3.50* = **Total amount of Recording Fees:** 14.00

* Total fees include \$3.00 Event Service Fee and \$.50 Recording fee per entry.

Were there any last minute judge changes or substitutions? Yes ☐ No ☒ Give reasons for each approved advertised judge or additional judge not judging his/her approved assignment.

Were there any complaints over the judging? Yes ☐ No ☒ If "Yes," please make complete report and attach.

Was the place where the Trial was held satisfactory? Yes ☒ No ☐ If "No," please submit a supplemental report giving details.

Was any protest against a dog made to the Field Trial Committee? Yes ☐ No ☒ If "Yes," attach a full report of the proceedings.

List names and members of Field Trial Committee who were present during the running of the Trial, and the approximate hours and dates each was present.

Jula Snowbaj 3/11/19
EVENT SECRETARY SIGNATURE DATE

Address: 509 SAFARI DR
SAN JOSE CA 95123

Tel/Email: 408 362-0328

*Recording Fees may be paid by credit card or by check - Do not submit form via Email, Mail or Fax only.

Payment Method: ☐ VISA ☐ AMEX ☐ MasterCard ☐ Discover ☐ Check or money order made payable to: The American Kennel Club

12345678901234567890 123456 123456
Account Number (do not include dashes) Expiration Date Printed Name of Cardholder

PO Box 900051

Raleigh, NC 27675-9051

Tel 919 816-3908

Fax 919 816-4211

Event Number: 2019255402

JUDGE'S BOOK FOR TRACKING
TD or TDU TDX AND VST
(Please Circle One)

Name of Club: PALO ALTO FOOTHILLS TRACKING ASSOCIATION, INC.

Date: 3/10/19 Judge: KATRIN BACKNIGHT

Scheduled Drawing Time: 10:00 AM Total No. Dogs to be Judged: 24 (3+AH)

Catalogue Numbers of Dogs Entered in the Test: X101, X102, X103, X104

PROCEDURE FOR JUDGES TO FOLLOW

For each dog entered, a separate track shall be plotted by one or both Judges for a TD or TDU tracking test, by both Judges for a TDX and a VST tracking test. The tracks shall be plotted at least the day prior to the test and marked by flags that the tracklayer can readily follow on the day of the test.

A set of charts consisting of one original and three (3) copies of each track shall be prepared by each Judge, showing the approximate length in yards of each leg, major landmarks and boundaries, if any. The track is to be charted by a solid line and each Judge will mark with a broken line, the approximate course taken by the dog, then complete the data requested on the chart and sign each chart. A separate chart must be prepared in the same manner for each dog.

Each Judges shall mark a chart at the time the dog is tracking, so as to show the approximate course followed by the dog. The Judges shall sign his/her charts and show on each whether the dog passed or failed and whether all requirements of the TD or TDU, TDX or VST test were met.

Information on the chart shall also include the following: (See Sample Charts)

Dog's Catalog No.	Track No.	Total Yards
Total Yards Veg.	Total Yards Non-Vegetation	Passed/Failed
Articles	Breed/Sex	AKC Reg. No.
Ground Conditions	Time Tracklayer Started	
Obstacles/Surfaces	Time X-Tracklayer Started	
Dog's Starting Time	Dog's Finishing Time	
Weather Conditions	Wind Direction at the Start	

If a dog is not tracking, it shall not be marked "passed" even though it may have found the article(s).

Upon completion of the test, the Tracking Secretary shall forward the marked copies of the charts to The American Kennel Club, and keep one set for the club files. Each Judge will retain a copy of all charts.

[Signature]
Signature of Judge

CLUB PAFTA DATE 3/10/19 EVENT # 2019285402

TD (TDX)

TRACK # 1 DOG'S CATALOG # 4103 TOTAL YDS 840

TDU VST

Chart the track in a solid line; the dog's course in broken line on graph below. VEG _____ NON-VEG _____

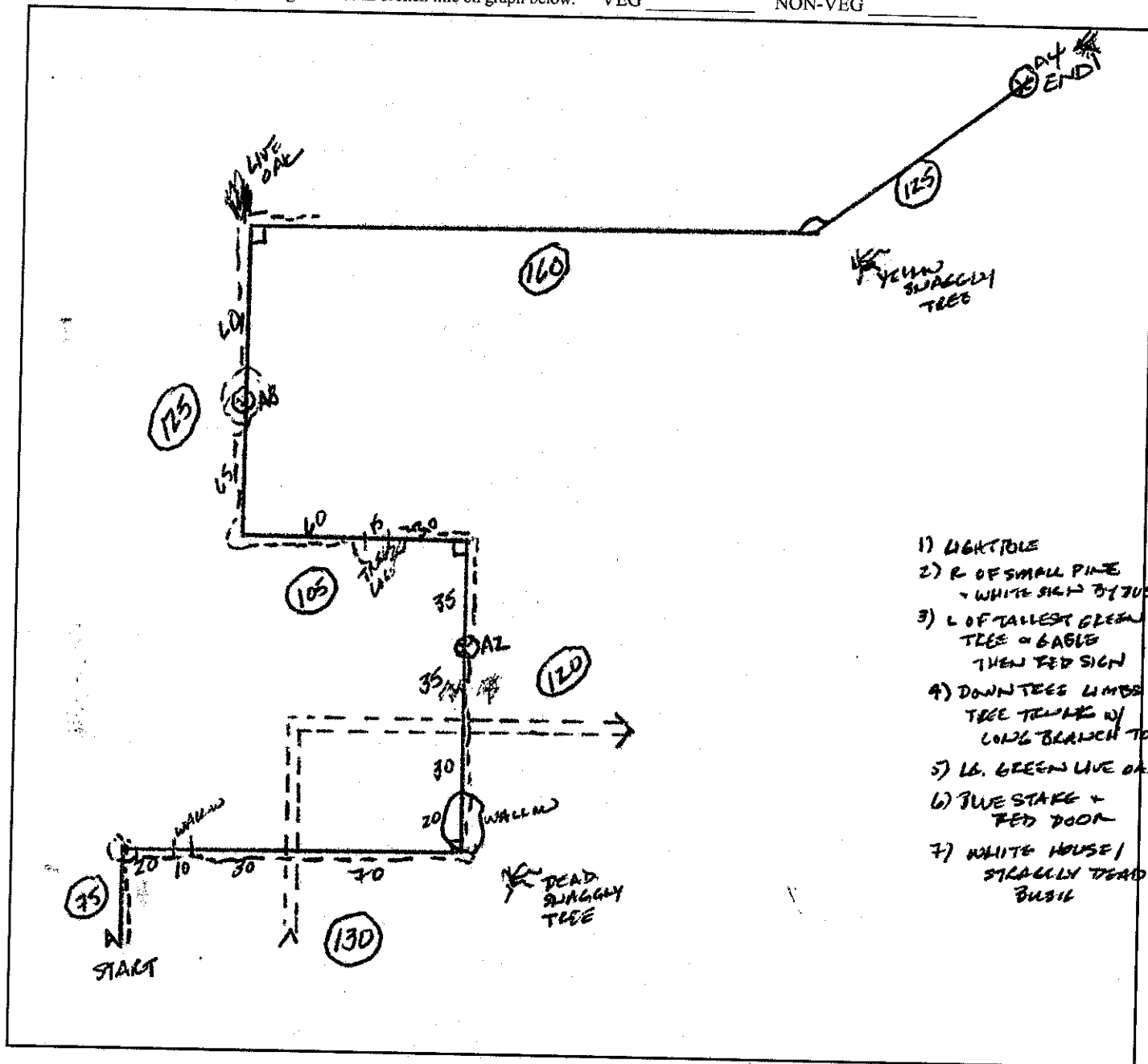

Time Tracklayer Started 7:30

Ground Conditions WET FIELD GRASS Breed WEIMARANER

Time X-tracker Started 9:00

Wind Conditions CALM Sex BLACK

Dog's Starting Time 10:32

Weather OVERCAST, COOL AKC # SR85897307

Dog's Finishing Time _____

If dog is absent, mark "absent" on the page.

PASSED (FAILED)

Articles

Obstacles/Surfaces

1. POLKAT (LLOTH) 2. SOCK

1. PIG WALL 2. PIG WALL

3. WEIRDOCK WOL 4. GLUE

3. TREES + LOGS 4. _____

I hereby certify that I have judged the above dog after having read the instructions on the cover of this book and followed them to the best of my ability.

Judge's Signature

CLUB PATIADATE 3/10/19EVENT # 201985402TD **TDX**TRACK # 1 DOG'S CATALOG # X103TOTAL YDS 840

TDU VST

Chart the track in a solid line; the dog's course in broken line on graph below.

VEG

NON-VEG

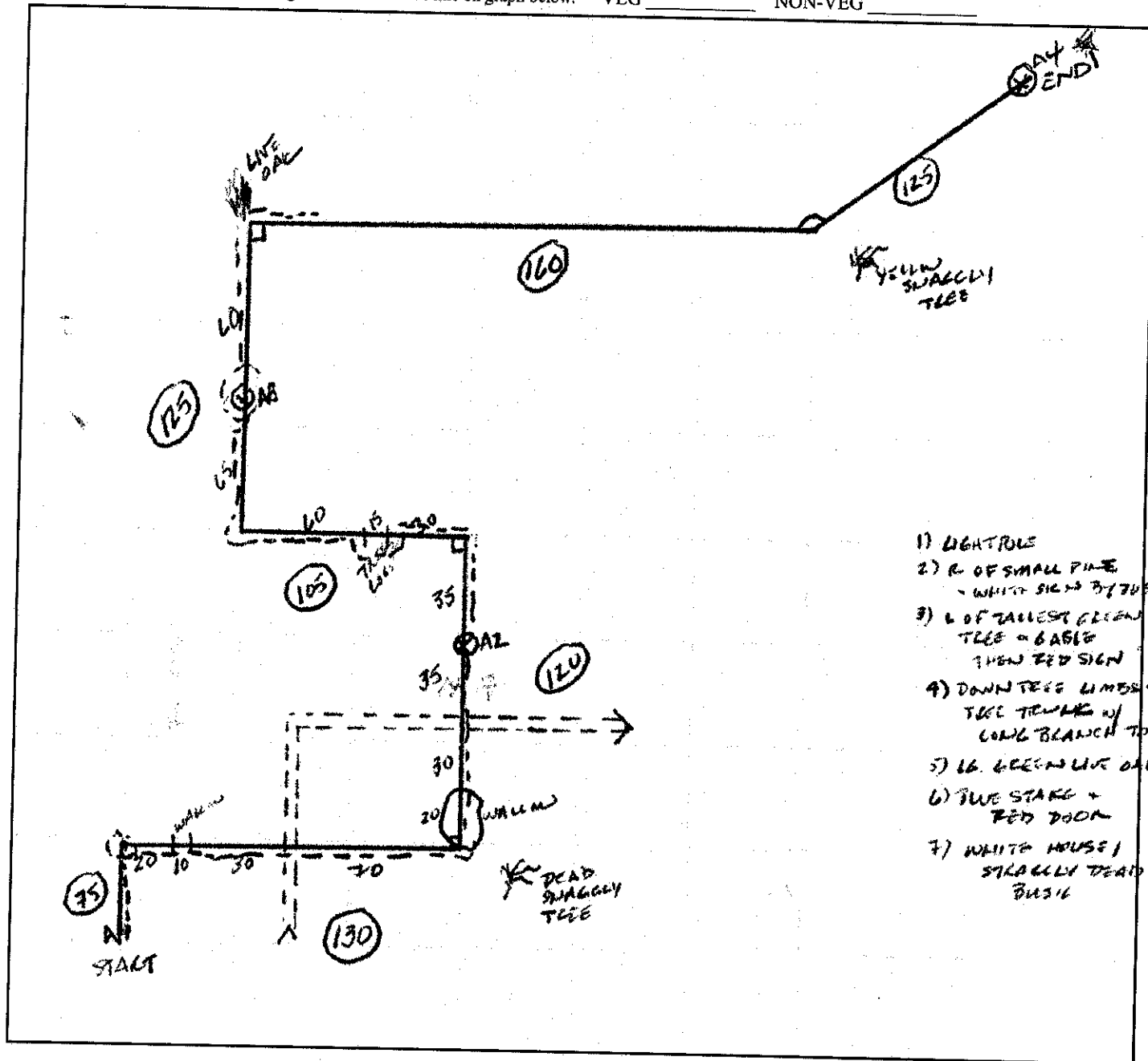

- 1) LIGHT POLE
- 2) R. OF SMALL PINE - WHITE SIGN 3/7/15H
- 3) L. OF TALLEST GREEN TREE - 6'6" THEN RED SIGN
- 4) DOWN TREE LIMBS - TREE TRUNK w/ LONG BRANCH TOP
- 5) 16. GREEN LIVE OAK
- 6) TWO STAKE - RED DOOR
- 7) WHITE HOUSE / STAGGLED DEAD BUSH

Time Tracklayer Started 7:30Ground Conditions WET FIELD GRASS Breed WEIMARANERTime X-tracker Started 9:00Wind Conditions CALMSex BREKDog's Starting Time 10:32Weather OVERCAST WINDAKC # SR85897302

Dog's Finishing Time

If dog is absent, mark "absent" on the page.

PASSED

FAILED

Articles

Obstacles/Surfaces

MISSED ARTICLE

(If failed, state reason)

1. FOLKES (LLOTH) 2. SOCK1. PIC WALL2. PIC WALL3. WICKED WHEEL 4. GLITE3. TREES + LOGS

4.

I hereby certify that I have judged the above dog after having read the instructions on the cover of this book and followed them to the best of my ability.

Judge's Signature

TD FDX

TRACK # 2 DOG'S CATALOG # X102 TOTAL YDS 540

TDU VST

Chart the track in a solid line; the dog's course in broken line on graph below. VEG _____ NON-VEG _____

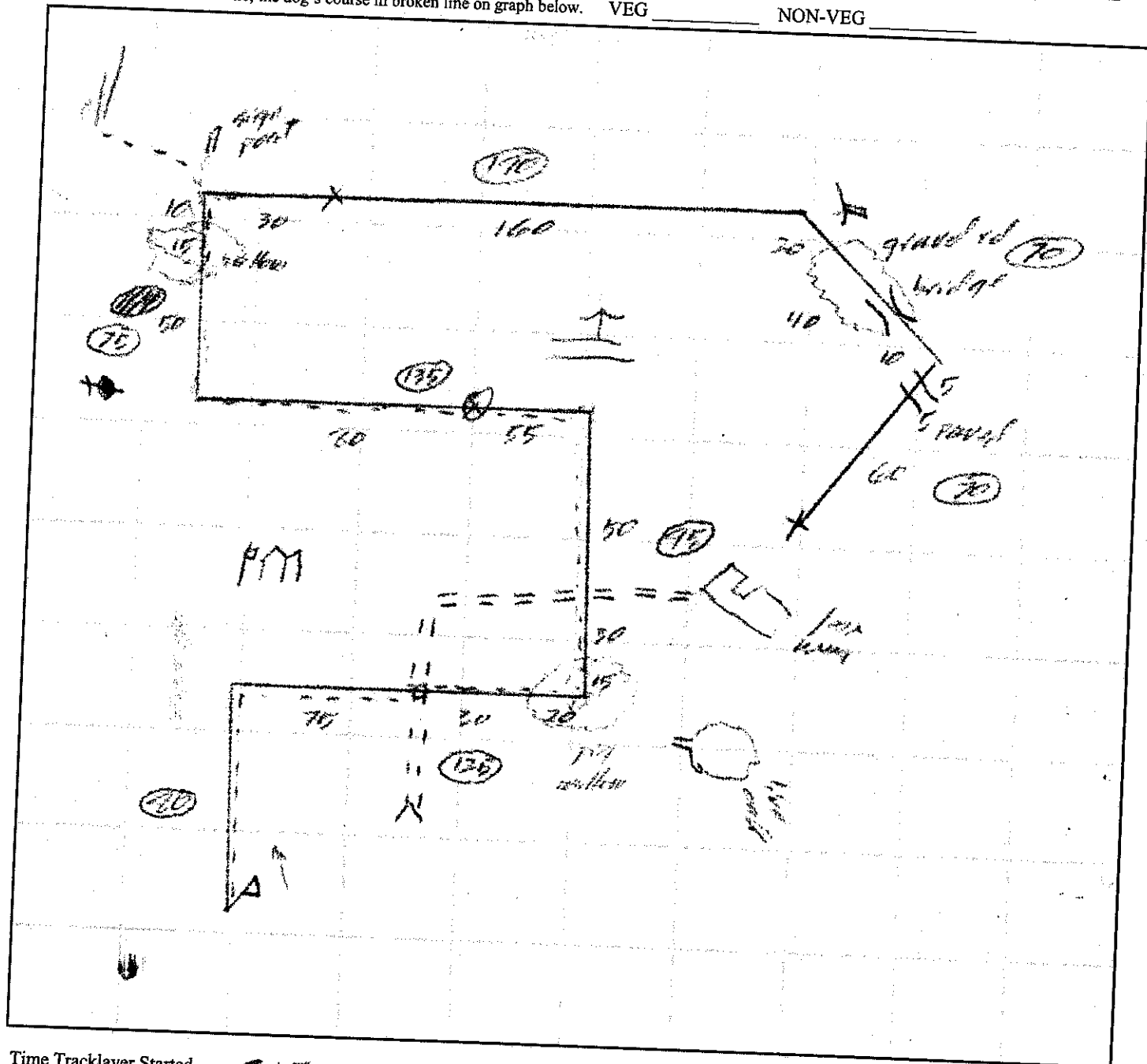

Time Tracklayer Started 3:15

Time X-tracker Started 945

Dog's Starting Time 1119

Dog's Finishing Time _____

Ground Conditions _____

Wind Conditions

Weather

Breed

Sex

AKC# 54759176

If dog is absent, mark "absent" on the page.

PASSED

FAILED

Articles

1. Jack 2. John

3. 4.

Obstacles/Surfaces

1. 10/10/10 2. 10/10/10

3. per day 4. per day

I hereby certify that I have judged the above dog after having read the instructions on the cover of this book and followed them to the best of my ability.

Judge's Signature

Judge's Signature

TD TDX
TDU VST

[illegible]

[Signature]
Judge's Signature

TD TDX
TDU VST

110 60 50 50 55 130 150 220 155 40 65 10 45 165 170 240 100 YDS

QUIT WALK 20 50 START

BUSH IN MIDDLE OF FIELD AT POLE BEHIND
 WHITE TABLE
 66 GREEN TREE TO L OF PHONE POLE
 PK GREEN TREE W/ TRUNK BEHIND
 DR. SHORT POST ON HILL W/ 2 BUSH PATCHES BEHIND
 TRANSFORMER
 PHONE POLE W/ STRIPES

Breed PORTUGUESE WATER DOG
Sex DOG
AKC # WS50857402

PASSED Q11 **FAILED**

(If failed, state reason)

1. WALLM (PIG) 2. PIG WALLM
3. DOWN TREE 18 CASH 4.

Judge's Signature

TD TDX

TDU VST

Chart the track in a solid line; the dog's course in broken line on graph below. VEG _____ NON-VEG _____

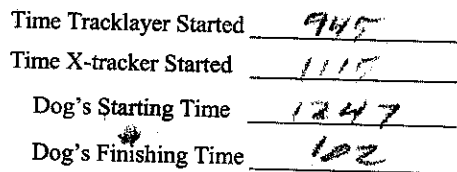

AKC# 2721621202

PASSED

FAILED

(If failed, state reason)

1. break pipe 2. pig pen

3. ~~January 11~~ 4. ~~January 11~~

I hereby certify that I have judged the above dog after having read the instructions on the cover of this book and followed them to the best of my ability.

Judge's Signature

Chart the track in a solid line; the dog's course in broken line on graph below. VEG _____ NON-VEG _____

